

# Application Case Story

## APPLICATION:

Plasma Cutting Torch

## MATERIAL:

Meldin® 7001

## PART DEFINITION:

Gas Distributor

## TECHNICAL DATA:

### TYPICAL DIMENSIONS:

.20" ID x .50" OD x .25" Length

SPEED: Static application

### WORKING TEMPERATURE:

700°F Max.

### ENVIRONMENT:

Plasma Gas

## FEATURES / BENEFITS:

- High dimensional stability
- Retains high strength at elevated temperatures
- Can withstand temporary excursions to 900°F

Meldin® 7001 was selected for this application due to its high temperature capability and direct formability. The material can withstand the extreme temperature generated in the torch head during the plasma cutting.

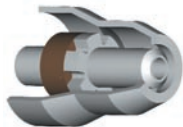

ASSEMBLED TORCH HEAD



MELDIN® GAS DISTRIBUTOR

Saint-Gobain  
Performance Plastics Corporation  
386 Metacom Avenue  
Bristol, Rhode Island 02809-5126

Tel: 401.253.2000  
Fax: 401.253.8211

ACS-410-1M-11015GCS

industrial  
equipment

